

UMP LAB PROFILE



FTEK

ETIM

CONCRETE &
MATERIAL
LAB

Version

22th September 2015

BASIC INFORMATION

Location:
FTEK, ETIM, Ground Floor

Cluster:
CONCRETE & MATERIAL

No	Item	Status
1	Area	11.20 m x 5.108 m
2	Supply	1 phase & 3 phase
3	Communication point	3 nos network, 1 nos phone
4	Gases	Compressed Air
5	AV System	No
6	Store	No
7	Bilik Persediaan Makmal	No
8	Air Conditioning	No
9	Others (utilities)	No

LIST OF EQUIPMENTS

Nature of Equipments

- This lab consist of concrete and material equipment.
- Experiments are related to the concrete and material testings.
- All equipment are from MTS, MATEST, PROCEQ and others.

No	Item	Quantity	Status	usage
1	COMPRESSION MACHINE	1	ok	PnP & RnD
2	FLEXURAL MACHINE	1	ok	PnP & RnD
3	UNIVERSAL TESTING MACHINE	1	ok	PnP & RnD
4	VEBE CONSISTOMETER APPARATUS	1	ok	PnP
5	ULTRA PULSE VELOCITY (UPV)	1	ok	PnP & RnD
6	UNIVERSAL OVEN	1	ok	PnP & RnD
7	VIBRATING TABLE	1	ok	PnP & RnD
8	SIEVE SHAKER	1	ok	PnP & RnD
9	SIEVE SET	1	ok	PnP & RnD
10	VICAT APPARATUS	1	ok	PnP
11	SLUMP TEST APPARATUS	1	ok	PnP
12	COMPACTING FACTOR APPARATUS	1	ok	PnP

LIST OF EQUIPMENTS

Nature of Equipments

- This lab consist of concrete and material equipment.
- Experiments are related to the concrete and material testings.
- All equipment are from MTS, MATEST, PROCEQ and others.

No	Item	Quantity	Status	usage
13	STEEL BEAM MOULD	20	ok	PnP
14	STEEL CYLINDER MOULD	15	ok	PnP
15	Proceq Hygropin	3	ok	PnP & RnD
16	Ultrasonic Pulse Velocity (UPV)	1	ok	PnP & RnD

LAB LAYOUT

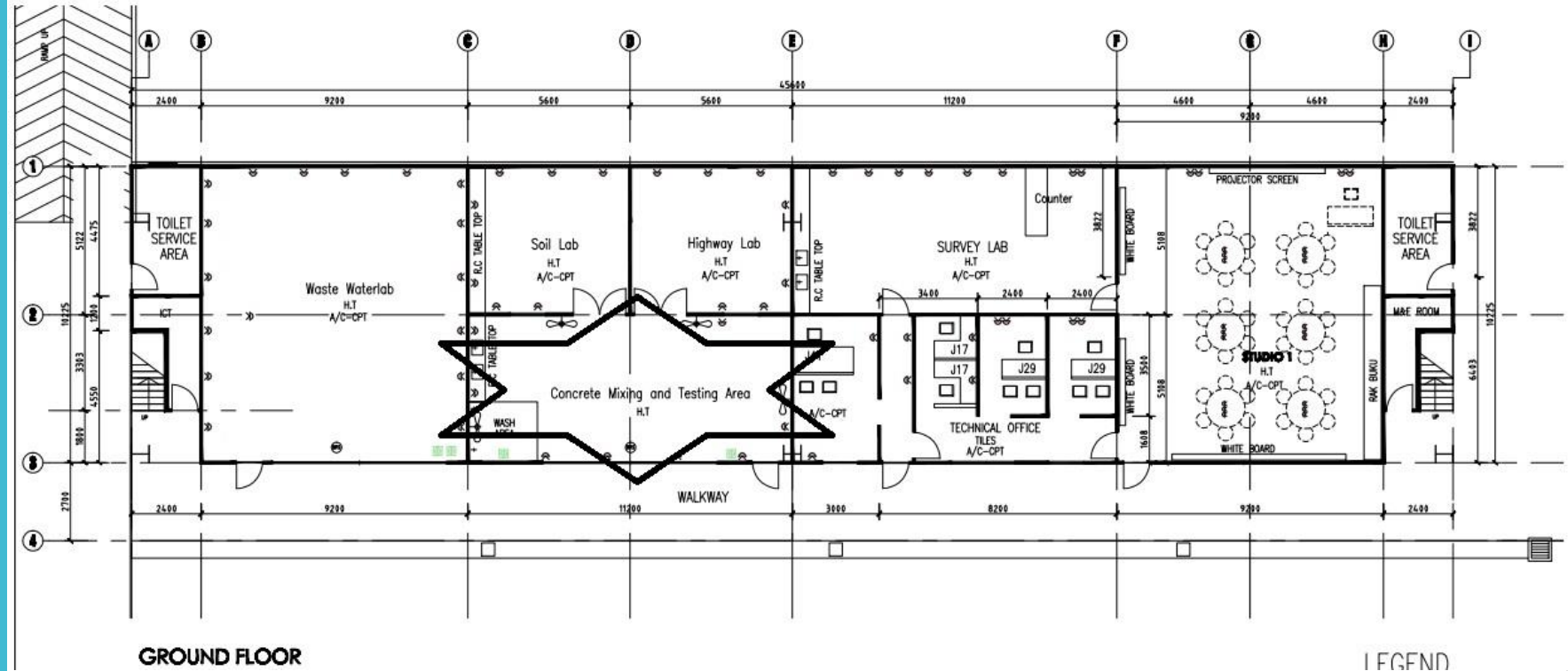

LAB PICTURES



LAB PICTURES

